



Whites Grounds Estate, London, SE1 3JX

Chain-free flat just off Bermondsey Street, within walking distance of London Bridge, the City and the South Bank.

The reception room and double bedroom both have wood flooring and fitted blinds. A separate kitchen includes a hob, oven, fridge and washing machine. A fully tiled shower room completes the accommodation.

Bermondsey Street's restaurants and independent bars are a two-minute walk away; Maltby Street and Borough Market are around five and ten minutes away. London Bridge Station is approx. 7 minutes away, with direct trains to Gatwick in under 30 minutes. Residents can apply for local parking permits and bicycle storage.

Years on Lease - 101

Annual Service Charge - £2,093.60

Annual Ground Rent - £10

Council Tax Band - B

Council tax, property size and, where applicable, lease information, service charges and ground rent are given as a guide only and should always be checked and confirmed by your Solicitor prior to exchange of contracts.

- Chain Free Apartment
- Bermondsey Street
- Easy Walk to London & Tower Bridge
- Separate Kitchen
- Fully Tiled Shower Room
- Car Parking Permit Available
- South-Facing Natural Light
- Oak Hardwood Flooring
- Riverside Walks

Alex & Matteo
ESTATE AGENTS

£350,000

White Grounds Estate SE1

Approximate Area = 450 sq ft / 41.8 sq m

For identification only - Not To Scale

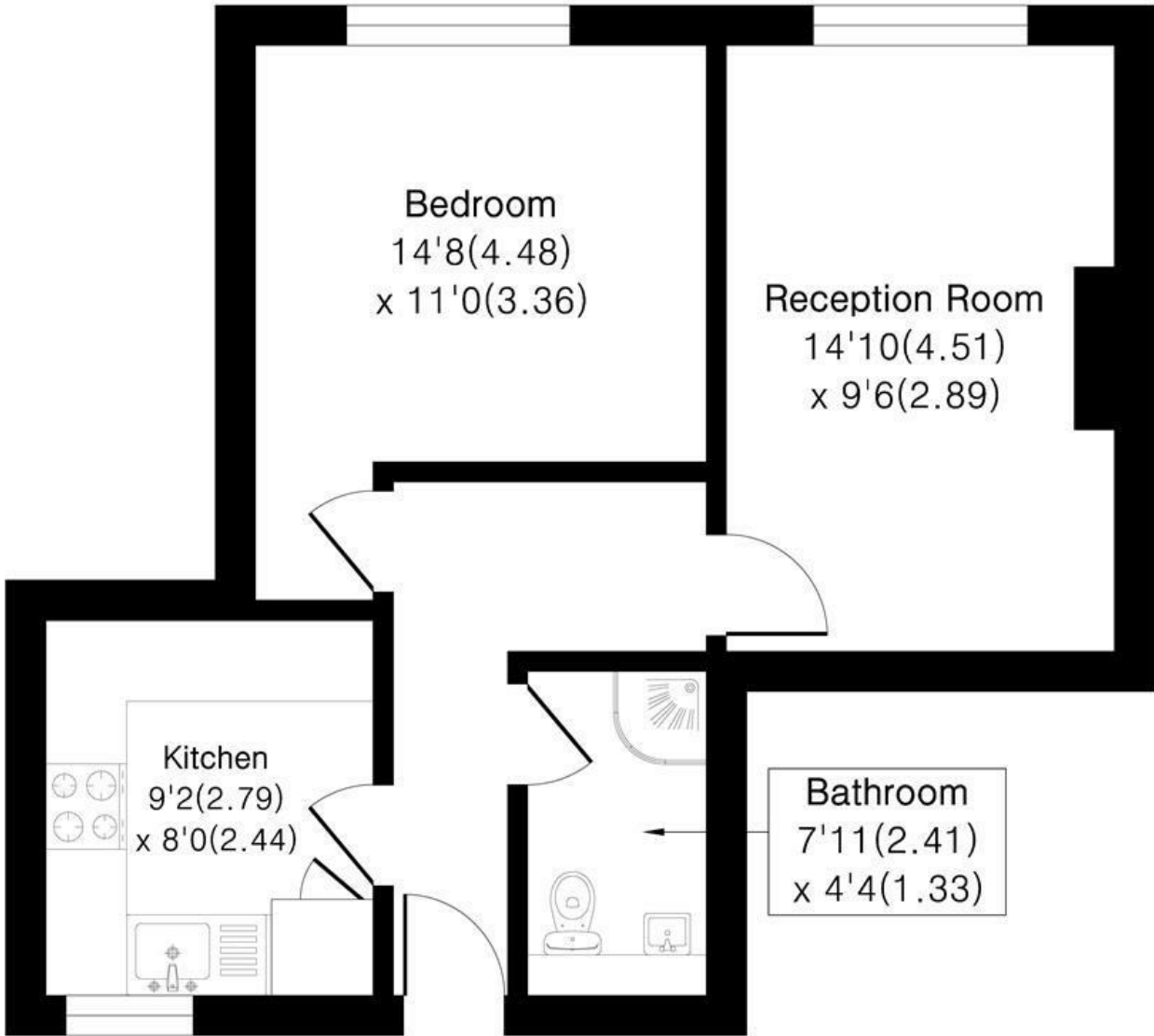

First Floor



Floor plan Produced in accordance with RICS Property Measurement 2nd Edition. Incorporating International Property Measurement Standards (IPMS2 Residential). Produced for Alex & Matteo Estate Agents.



Energy Efficiency Rating		Current	Potential
Very energy efficient - lower running costs			
(92 plus) A			
(81-91) B			
(69-80) C			
(55-68) D			
(39-54) E			
(21-38) F			
(1-20) G			
Not energy efficient - higher running costs			
		71	80
England & Wales		EU Directive 2002/91/EC	